

Nakano Campus Entry MAP

【From Wednesday, February 4, 2026 to Tuesday, March 31, 2026】

1F



© On February 4 and 5, entry to the Nakano Campus will be strictly limited to authorized personnel due to the entrance exam. All administrative offices and facilities will be closed.

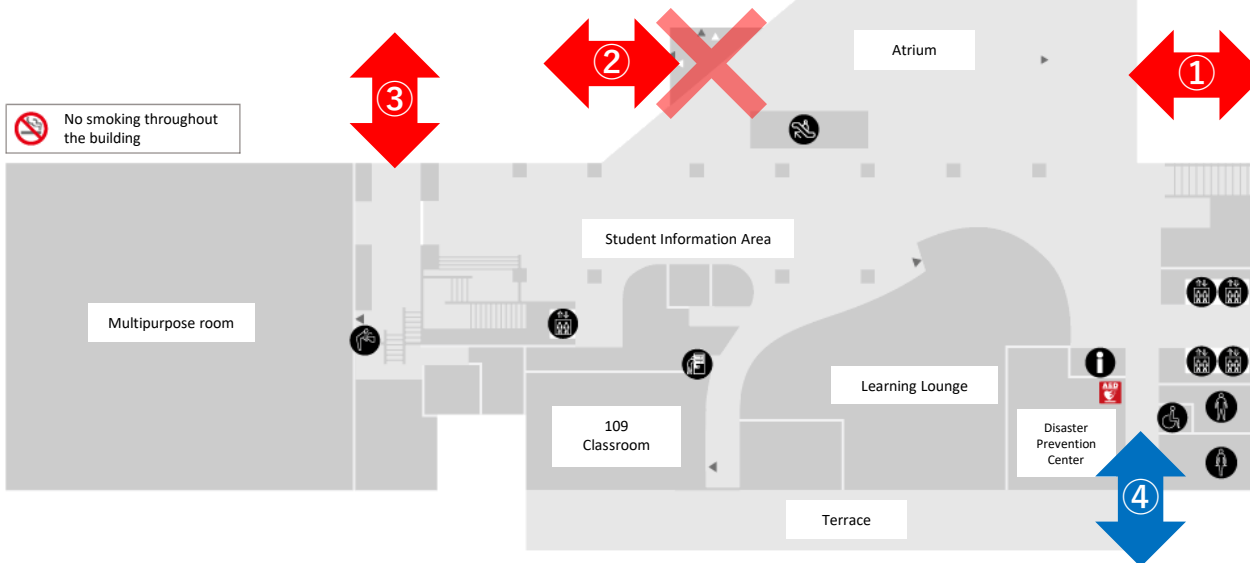

Entry Hours

①③

(Students, faculty & staff,
on-site contractors only)

【Weekday】 8:30~17:30 *

【Sat】 8:30~13:00 *

【Sun and holiday】 Closed

* Exit only through ③ during the
following hours.

(No entry allowed.)

【Weekday】 17:30~22:30

【Sat】 13:00~22:30

②

(Students, faculty & staff,
on-site contractors only)

【Everyday】 Closed

④

【Everyday】 7:00~22:30

© Non-university personnel should
enter through ④ and register at
Disaster Prevention Center.
Access to classrooms, study
rooms, library, research lab
areas (7th-14th floors of the
High-Rise Wing), and other
student and faculty facilities
is restricted to authorized
personnel.

⑤

【Weekday】 10:00~15:30

【Sat, Sun and holiday】 Closed