

STEP1 Setup

***Suspended camera and classroom microphones are used.**



Take out [Camera remote control] from storage tray for remotes/cables.



STEP2 Zoom microphone & camera configuration

Sound from classroom microphones (both wired and wireless) is sent to Zoom via Classroom PC.

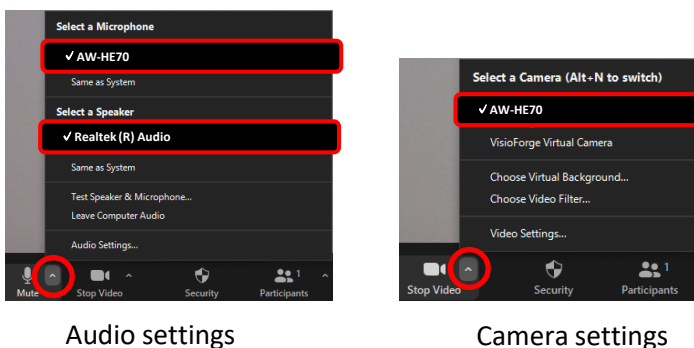

Mic.: AW-HE70 (classroom microphones)
Speakers: Realtek (R) Audio (classroom speakers)
Camera: AW-HE70 (suspended camera)

***Check detailed description of remote-control functions overleaf.**

Camera view adjustment

<To use presets>

- Press **[Preset Memory]** buttons to use angle/view preset options.

Camera Presets

- 1: Teaching Platform panoramic view
- 2: Teacher's Desk panoramic view
- 3: Whiteboard (window side)
- 4: Whiteboard (hallway side)
- 5: Whiteboard panoramic view



Preset1: Teaching Platform panoramic view



Preset2: Teacher's Desk panoramic view



[Preset3: Whiteboard (window side)]



Preset4: Whiteboard (hallway side)



Preset5: Whiteboard panoramic view

* differ depending on classroom

<To adjust angle/view manually>

- Use **[Pan/Tilt]** buttons to change camera direction/angle.
- Use **[ZOOM]** buttons to adjust view.

<To adjust Camera slightly>

- Long press **[SLOW]** button to make camera move slowly.

<When Camera is unresponsive>

- Press **[CAM 1]**.

